

TABLE MOUNTABLE MODULAR A/V CONNECTOR BAYS

Table Mount

CPM200 / CPM208

Connector Bays Install in a Conference / Boardroom Table, Podium, Instructor's Station or Other Custom Furniture



CPM200

Modular Faceplate

Accepts Up to Three A/V Connector Modules

CPM208 Modular Faceplate Accepts Up to Eight A/V Connector Modules

- **Over 75 Connector Modules Available** Featuring Popular Video, Audio, Phone, Data, and Control Connectors. INLINE can provide custom engraving (extra charge) to label connectors.

- **CM Series Active A/V Connector Modules** Active Modules are Available for VGA Line Driving, Audio Buffering, Twisted Pair Transmission, Control and A/C Power
- **Captive Cable Kits** — A/V Module Kits with 1–3 Holes in the Surface Allow Cables to Be Permanently Installed in the Connector Bay and Pulled Out as Needed. Captive Cable Installations Provide Great Ease of Use and Low Maintenance Since the A/V Cables are Always There and Can't be Lost or Borrowed.
- **Modular Design Prevents Obsolescence** Install New Modules to Accommodate System Changes

- **Modular Faceplate Carriage(s)** Can Be Installed in Upper Position or Lower Position Depending on Application.
- **Adjustable Brackets Accommodate** Table Top Thickness from 0.5" to 2.5"
- **Cable Management** — Tie Points are Included on the Bottom Edge of the CPM200 / CPM208 to Facilitate Cable Strain relief. The Tie Points also Make it Easy to Create Cable Loops for Captive Cable Installations.

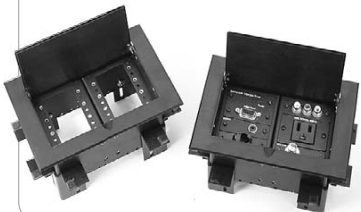

CAPTIVE CABLE KITS FOR CPM200 AND CPM208



IN9484B INSTALLED IN CPM200

IN9482B

(1) Large Cable Hole —

Kit Includes:

(2) Single Space Plates and (1) Grommet (13/16" ID)

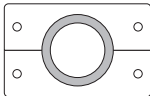

IN9483B

(2) Small Cable Holes —

Kit Includes:

(2) Single Space Plates and 2 Grommets (5/16" ID)

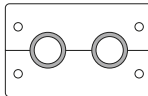

IN9484B

(1) Large Cable Hole and

(2) Small Cable Holes —

Kit Includes:

(3) Single Space Plates and 3 Grommets

(One 13/16" ID and Two 5/16" ID)

